



CSW Industrials Companies

LF Series

Linear Bar Floor Diffusers and Grilles (Type 7)

MODEL: LF-T7

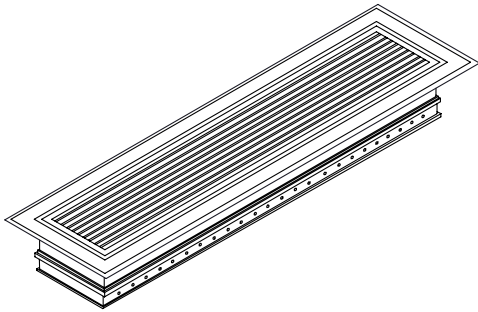

Standard Frame Width

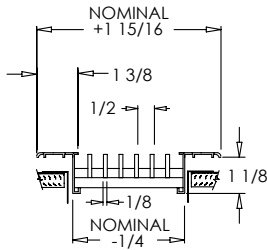

LF 1/2 0°
STANDARD FRAME

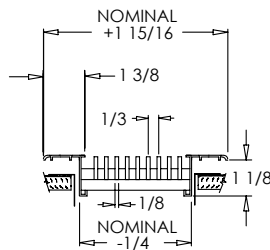

LF 1/3 0°
STANDARD FRAME

Y Frame Width (not available with Mill Finish)

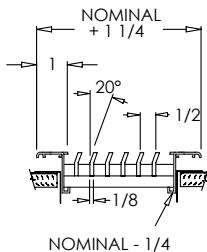

LF 1/2 20°
Y FRAME

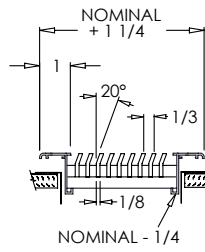

LF 1/3 20°
Y FRAME

Standard Features:

- Precision aluminum construction for clean styling and efficient air distribution
- Extruded aluminum frame with signature line marks
- 1 3/8" frame width
- Reinforced with pressure lock honeycomb construction to withstand heavy foot traffic
- Available in lengths up to 144" in one piece (may vary for shipping and manufacturing considerations)
- Maximum available width is 14"
- 1/8" thick core blades run parallel to longest dimension
- 1/2" spacing with 0° or 20° deflection; actual spacing between bars is 3/8"
- 1/3" spacing with 0° or 20° deflection; actual spacing between bars is 3/16"
- Satin Anodized

Options:

- Recessed screwdriver-operated opposed blade damper – 1/2" spacing (OBD)
- Lever-operated opposed blade damper – 1/3" spacing (OBD)
- Extruded aluminum adjustable curved blade air deflection grid (Grid)
- Screwdriver-operated opposed blade damper with extruded aluminum adjustable curved blade air deflection grid (not available with 1/3" spacing)
- Heavy Duty with welded support brackets and frame, and extra center margin supports (HD)
- Short Blades: core blades run parallel to shortest dimension
- Special Shapes: mitered and custom shapes diffusers (see website for more details)
- Butt joints for continuous lengths
- Fractional I.D. and O.D. sizes available

Blade Spacing Options:

- 1/2" - 0° Deflection
- 1/3" - 0° Deflection
- 1/2" - 20° Deflection
- 1/3" - 20° Deflection

Frame Widths:

- 1 3/8" Frame (standard)
- 1" Frame (option Y) (not available with Mill Finish)

Finishes:

STANDARD COLORS

- Soft White
- Driftwood Tan
- Mill Finish
- Satin Anodized

DESIGNER COLORS

- Black
- Bronze
- Storm Gray
- Cement Gray

- Aluminum Paint
- Coffee Tan
- Warm White
- Glossy White

Additional Information:

Submittal Notes

Project / Location:

Engineer:

Architect:

Contractor:



LF Series

Linear Bar Floor Diffusers and Grilles (Type 7)

MODEL: LF-T7

CSW Industrials Companies

OBD & Grid Options:

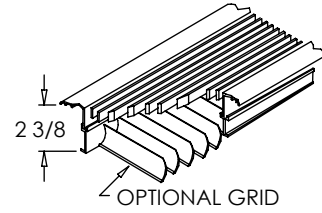
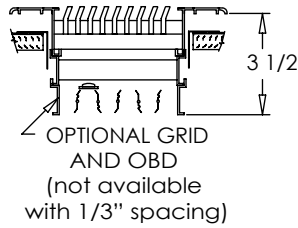
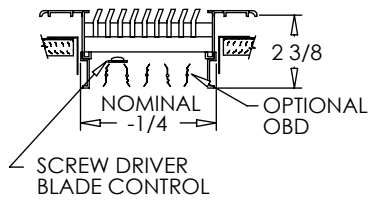

FRAME OPTIONS:

Standard Frame Length

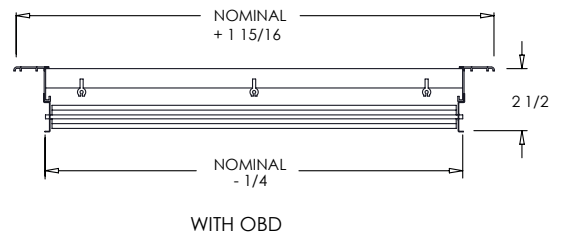
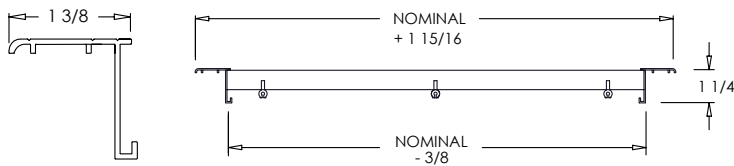

Y Frame Length (not available with Mill Finish)

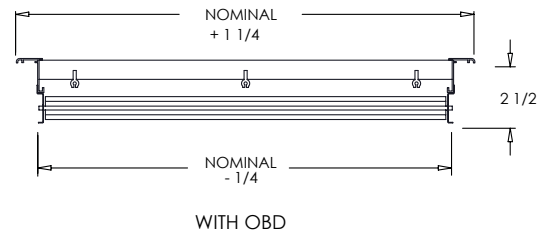
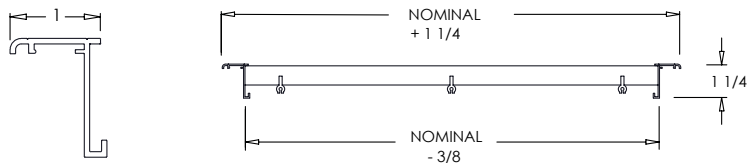

Additional Information:

Submittal Notes

Project / Location:	
Engineer:	
Architect:	
Contractor:	